

T2C3 CONFIGURATIONS

Tactical TEMPEST Command and Center Centers

VIDEO TELECONFERENCING AND CONTENT DELIVERY SYSTEMS

TACTICAL LAN SYSTEMS

SECURE MOBILE OFFICE SYSTEMS

Tactical LAN with Video Distribution
Rack mount system with SkyStream EMR

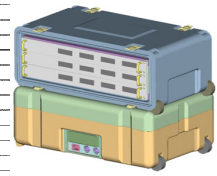

Application
Basic hardware needed for Network operations and connectivity

Functionality
Single case with 24 port Catalyst Switch, Modular router with modules, Micro EMR from SkyStream

Configured Item Price \$ 15,334

Single User at 64K ISDN Data Rate
2100T Series with KIV 7 and TA

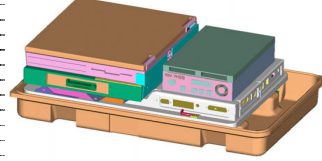

Application

Functionality

Configured Item Price \$ 49,489

Single User at 56K Analog Data Rate
2200TL Series with Sectera



Application

Functionality

Configured Item Price \$ 39,531

Single User at 128K ISDN Data Rate
2100T together with 2100TS

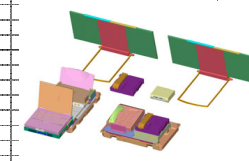

Application

Functionality

Configured Item Price \$ 65,391

LAN with HUBS and Routers
2300 Series System with HUBS and Routers

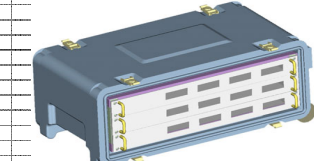

Application

Functionality

Configured Item Price \$ 66,267

Single User at 56K Analog Data Rate
2200TL Series with Sectera



Application

Functionality

Configured Item Price \$ 29,679

Single User at 64K ISDN Data Rate
2100T together with OMNI and TA



Application

Functionality

Configured Item Price \$ 41,710

GSA Schedule		Part #		Description		Qty	Price	Integrator System Platforms		Description		Qty	Price	Integrator System Platforms		Description		Qty	Price	Integrator System Platforms		Description		Qty	Price
C00090	\$ 16,097	x	2100T	Secure Computer-Satellite	0	\$ -		2100T	Secure Computer-Satellite	1	\$ 16,097			2100T	Secure Computer-Satellite	0	\$ -	2100T	Secure Computer-Satellite	0	\$ -	2100T	Secure Computer-Satellite	1	\$ 16,097
C00121	\$ 9,519	x	2100TS	Secure Satellite Comm	0	\$ -		2100TS	Secure Satellite Comm	0	\$ -			2100TS	Secure Satellite Comm	1	\$ 9,519	2100TS	Secure Satellite Comm	0	\$ -	2100TS	Secure Satellite Comm	0	\$ -
C00122	\$ 9,519	x	2100TD	Dual Satellite	0	\$ -		2100TD	Dual Satellite	0	\$ -			2100TD	Dual Satellite	0	\$ -	2100TD	Dual Satellite	0	\$ -	2100TD	Dual Satellite	0	\$ -
C00123	\$ 15,377	x	2100TT	TEMPEST	0	\$ -		2100TT	TEMPEST	0	\$ -			2100TT	TEMPEST	0	\$ -	2100TT	TEMPEST	0	\$ -	2100TT	TEMPEST	0	\$ -
C00124	\$ 10,252	x	2100TN	19" Rack	0	\$ -		2100TN	19" Rack	0	\$ -			2100TN	19" Rack	0	\$ -	2100TN	19" Rack	0	\$ -	2100TN	19" Rack	0	\$ -
C00126	\$ 8,787	x	2200TN	19" Rack	0	\$ -		2200TN	19" Rack	0	\$ -			2200TN	19" Rack	0	\$ -	2200TN	19" Rack	0	\$ -	2200TN	19" Rack	0	\$ -
C00222	\$ 8,787	x	2200TL	Leightweight Satellite	0	\$ -		2200TL	Leightweight Satellite	0	\$ -			2200TL	Leightweight Satellite	1	\$ 8,787	2200TL	Leightweight Satellite	0	\$ -	2200TL	Leightweight Satellite	0	\$ -
C00227	\$ 9,885	x	2200TS	Secure Tactical Comm	0	\$ -		2200TS	Secure Tactical Comm	0	\$ -			2200TS	Secure Tactical Comm	0	\$ -	2200TS	Secure Tactical Comm	0	\$ -	2200TS	Secure Tactical Comm	0	\$ -
C00228	\$ 7,323	x	2300TN	19" Rack	1	\$ 7,323		2300TN	19" Rack	0	\$ -			2300TN	19" Rack	1	\$ 7,323	2300TN	19" Rack	0	\$ -	2300TN	19" Rack	0	\$ -
C00139	\$ 5,808	x	2200BP	670 W-Hr @ 13 VDC	0	\$ -		2200BP	670 W-Hr @ 13 VDC	0	\$ -			2200BP	670 W-Hr @ 13 VDC	1	\$ 5,808	2200BP	670 W-Hr @ 13 VDC	0	\$ -	2200BP	670 W-Hr @ 13 VDC	0	\$ -
C00229	\$ 1,667	x	2300DT	Desktop	0	\$ -		2300DT	Desktop	0	\$ -			2300DT	Desktop	1	\$ 1,667	2300DT	Desktop	0	\$ -	2300DT	Desktop	0	\$ -
C00230	\$ 556	x	2100MT	Empty Case for Storage	0	\$ -		2100MT	Empty Case for Storage	0	\$ -			2100MT	Empty Case for Storage	0	\$ -	2100MT	Empty Case for Storage	0	\$ -	2100MT	Empty Case for Storage	0	\$ -
C00231	\$ 444	x	2200MT	Empty Case for Storage	0	\$ -		2200MT	Empty Case for Storage	0	\$ -			2200MT	Empty Case for Storage	0	\$ -	2200MT	Empty Case for Storage	0	\$ -	2200MT	Empty Case for Storage	0	\$ -
C00232	\$ 722	x	2300MT	Empty Case for Storage	0	\$ -		2300MT	Empty Case for Storage	0	\$ -			2300MT	Empty Case for Storage	0	\$ -	2300MT	Empty Case for Storage	0	\$ -	2300MT	Empty Case for Storage	0	\$ -
C00233	\$ 2,929	x	Enclosure	for OMNI Xi with TA/ M4 Bond	0	\$ -		Enclosure	for OMNI Xi with TA/ M4 Bond	0	\$ -			Enclosure	for OMNI Xi with TA/ M4 Bond	0	\$ -	Enclosure	for OMNI Xi with TA/ M4 Bond	0	\$ -	Enclosure	for OMNI Xi with TA/ M4 Bond	1	\$ 2,929
C00234	\$ 2,929	x	Enclosure	for KIV 7with TA/ M4 Bond	0	\$ -		Enclosure	for KIV 7with TA/ M4 Bond	1	\$ 2,929			Enclosure	for KIV 7with TA/ M4 Bond	0	\$ -	Enclosure	for KIV 7with TA/ M4 Bond	0	\$ -	Enclosure	for KIV 7with TA/ M4 Bond	0	\$ -
C00235	\$ 1,757	x	1U	Power Interface Unit for 2300	0	\$ -		1U	Power Interface Unit for 2300	0	\$ -			1U	Power Interface Unit for 2300	0	\$ -	1U	Power Interface Unit for 2300	0	\$ -	1U	Power Interface Unit for 2300	0	\$ -
C00236	\$ 1,757	x	3U	Power Interface Unit for 2300	0	\$ -		3U	Power Interface Unit for 2300	0	\$ -			3U	Power Interface Unit for 2300	0	\$ -	3U	Power Interface Unit for 2300	0	\$ -	3U	Power Interface Unit for 2300	0	\$ -
C00103	\$ 12,702	x	INMARSAT	M4	0	\$ -		INMARSAT	M4	1	\$ 12,702			INMARSAT	M4	2	\$ 25,404	INMARSAT	M4	0	\$ -	INMARSAT	M4	1	\$ 12,702
C00164	\$ 2,912	x	Sectera	Wireline Terminal Type 1	0	\$ -		Sectera	Wireline Terminal Type 1	0	\$ -			Sectera	Wireline Terminal Type 1	0	\$ -	Sectera	Wireline Terminal Type 1	0	\$ -	Sectera	Wireline Terminal Type 1	1	\$ 2,912
C00237	\$ 2,368	x	Klashing	200 PCMCIA	0	\$ -		Klashing	200 PCMCIA	0	\$ -			Klashing	200 PCMCIA	0	\$ -	Klashing	200 PCMCIA	0	\$ -	Klashing	200 PCMCIA	0	\$ -
C00238	\$ 2,368	x	Klashing	400 PCMCIA	0	\$ -		Klashing	400 PCMCIA	0	\$ -			Klashing	400 PCMCIA	0	\$ -	Klashing	400 PCMCIA	0	\$ -	Klashing	400 PCMCIA	0	\$ -
C00239	\$ 2,991	x	Klashing	600 PCMCIA	0	\$ -		Klashing	600 PCMCIA	1	\$ 2,991			Klashing	600 PCMCIA	2	\$ 5,982	Klashing	600 PCMCIA	0	\$ -	Klashing	600 PCMCIA	0	\$ -
C00240	\$ 822	x	Klashing	M4 S/T ISDN Adapter	0	\$ -		Klashing	M4 S/T ISDN Adapter	0	\$ -			Klashing	M4 S/T ISDN Adapter	0	\$ -	Klashing	M4 S/T ISDN Adapter	0	\$ -	Klashing	M4 S/T ISDN Adapter	0	\$ -
C00241	\$ 1,692	x	Klashing	M4 S/T 128K (dual card)	0	\$ -		Klashing	M4 S/T 128K (dual card)	0	\$ -			Klashing	M4 S/T 128K (dual card)	0	\$ -	Klashing	M4 S/T 128K (dual card)	0	\$ -	Klashing	M4 S/T 128K (dual card)	0	\$ -
C00242	\$ 2,368	x	Klashing	HSD PCI-232	0	\$ -		Klashing	HSD PCI-232	0	\$ -			Klashing	HSD PCI-232	0	\$ -	Klashing	HSD PCI-232	0	\$ -	Klashing	HSD PCI-232	0	\$ -
C00243	\$ 2,368	x	Klashing	HSD PCI-530	0	\$ -		Klashing	HSD PCI-530	0	\$ -			Klashing	HSD PCI-530	0	\$ -	Klashing	HSD PCI-530	0	\$ -	Klashing	HSD PCI-530	0	\$ -
C00244	\$ 2,368	x	Klashing	HSD PCI-449	0	\$ -		Klashing	HSD PCI-449	0	\$ -			Klashing	HSD PCI-449	0	\$ -	Klashing	HSD PCI-449	0	\$ -	Klashing	HSD PCI-449	0	\$ -
C00245	\$ 2,368	x	Klashing	HSD PCI-X-21	0	\$ -		Klashing	HSD PCI-X-21	0	\$ -			Klashing	HSD PCI-X-21	0	\$ -	Klashing	HSD PCI-X-21	0	\$ -	Klashing	HSD PCI-X-21	0	\$ -
C00246	\$ 2,261	x	ISDN	Bonder/Terminal Adapter	0	\$ -		ISDN	Bonder/Terminal Adapter	1	\$ 2,261			ISDN	Bonder/Terminal Adapter	0	\$ -	ISDN	Bonder/Terminal Adapter	0	\$ -	ISDN	Bonder/Terminal Adapter	0	\$ -
C00256	\$ 5,236	x	STE	(Office)	0	\$ -		STE	(Office)	0	\$ -			STE	(Office)	0	\$ -	STE	(Office)	0	\$ -	STE	(Office)	0	\$ -
C00257	\$ 3,932	x	OMNI		0	\$ -		OMNI		0	\$ -			OMNI		0	\$ -	OMNI		0	\$ -	OMNI		1	\$ 3,932
C00258	\$ 3,654	x	SECURE	LAN PC Card (Secret 11)	0	\$ -		SECURE	LAN PC Card (Secret 11)	0	\$ -			SECURE	LAN PC Card (Secret 11)	0	\$ -	SECURE	LAN PC Card (Secret 11)	0	\$ -	SECURE	LAN PC Card (Secret 11)	0	\$ -
C00259	\$ 2,166	x	SECURE	Wireless Bridge	0	\$ -		SECURE	Wireless Bridge	0	\$ -			SECURE	Wireless Bridge	0	\$ -	SECURE	Wireless Bridge	0	\$ -	SECURE	Wireless Bridge	0	\$ -
C00260	\$ 1,448	x	SECURE	Access Point	0	\$ -		SECURE	Access Point	0	\$ -			SECURE	Access Point	0	\$ -	SECURE	Access Point	0	\$ -	SECURE	Access Point	0	\$ -
C00274	\$ 1,728	x	Modular	Router, 19" w/o modules	1	\$ 1,728		Modular	Router, 19" w/o modules	0	\$ -			Modular	Router, 19" w/o modules	0	\$ -	Modular	Router, 19" w/o modules	0	\$ -	Modular	Router, 19" w/o modules	0	\$ -
C00276	\$ 788	x	2 Port	Serial WAN Interface Card	1	\$ 788		2 Port	Serial WAN Interface Card	0	\$ -			2 Port	Serial WAN Interface Card	1	\$ 788	2 Port	Serial WAN Interface Card	0	\$ -	2 Port	Serial WAN Interface Card	0	\$ -
C00277	\$ 788	x	1 Port	56/64 WAN Interface Card	1	\$ 788		1 Port	56/64 WAN Interface Card	0	\$ -			1 Port	56/64 WAN Interface Card	0	\$ -	1 Port	56/64 WAN Interface Card	0	\$ -	1 Port	56/64 WAN Interface Card	0	\$ -
C00278	\$ 703	x	1 Port	ISDN WAN Interface Card	1	\$ 703		1 Port	ISDN WAN Interface Card	0	\$ -			1 Port	ISDN WAN Interface Card	1	\$ 703	1 Port	ISDN WAN Interface Card	0	\$ -	1 Port	ISDN WAN Interface Card	0	\$ -
C00281	\$ 877	x	2 Port	Analog Modem WAN Interface	0	\$ -		2 Port	Analog Modem WAN Interface	0	\$ -			2 Port	Analog Modem WAN Interface	1	\$ 877	2 Port	Analog Modem WAN Interface	0	\$ -	2 Port	Analog Modem WAN Interface	0	\$ -
C00284	\$ 337	x	1 Port	10BT Ethernet WAN Interface Card	1	\$ 337		1 Port	10BT Ethernet WAN Interface Card	0	\$ -			1 Port	10BT Ethernet WAN Interface Card	0	\$ -	1 Port	10BT Ethernet WAN Interface Card	0	\$ -	1 Port	10BT Ethernet WAN Interface Card	0	\$ -
C00285	\$ 1,800	x	Catalyst	Switch	1	\$ 1,800		Catalyst	Switch	0	\$ -			Catalyst	Switch	1	\$ 1,800	Catalyst	Switch	0	\$ -	Catalyst	Switch	0	\$ -
C00286	\$ 3,071	x	Mobile	Access Router (3200B)	0	\$ -		Mobile	Access Router (3200B)	0	\$ -			Mobile	Access Router (3200B)	0	\$ -	Mobile	Access Router (3200B)	0	\$ -	Mobile	Access Router (3200B)	0	\$ -
C00287	\$ 5,196	x	Mobile	Access Router Component (3251)	0	\$ -		Mobile	Access Router Component (3251)	0	\$ -			Mobile	Access Router Component (3251)	0	\$ -	Mobile	Access Router Component (3251)	0	\$ -	Mobile	Access Router Component (3251)	0	\$ -
C00289	\$ 1,560	x	Mobile	Access Router Component (FESMIC)	0	\$ -		Mobile	Access Router Component (FESMIC)	0	\$ -			Mobile	Access Router Component (FESMIC)	0	\$ -	Mobile	Access Router Component (FESMIC)	0	\$ -	Mobile	Access Router Component (